

J.P. STEVENS & CO., INC.
REF DWG. NO. 154-132

FILED
GREENVILLE CO. S.C.
NOV 12 11 53 AM '74
DONNIE S. TANKERSLEY
R.M.C.

WAYMON FAXTER, ET AL.
REF DWG. NO. 4-285

ROBERT L. FLANAGAN
REF DWG. NO. 3-880

J.P. STEVENS & COMPANY, INC.
REF DWG. NO. 3-876

CANNIE T. SIMPSON
REF DWG. NO. 3-897

J.P. STEVENS & CO., INC.
REF DWG. NO. 154-132

CANNIE T. SIMPSON
REF DWG. NO. 3-897

CANNIE T. SIMPSON
REF DWG. NO. 3-897

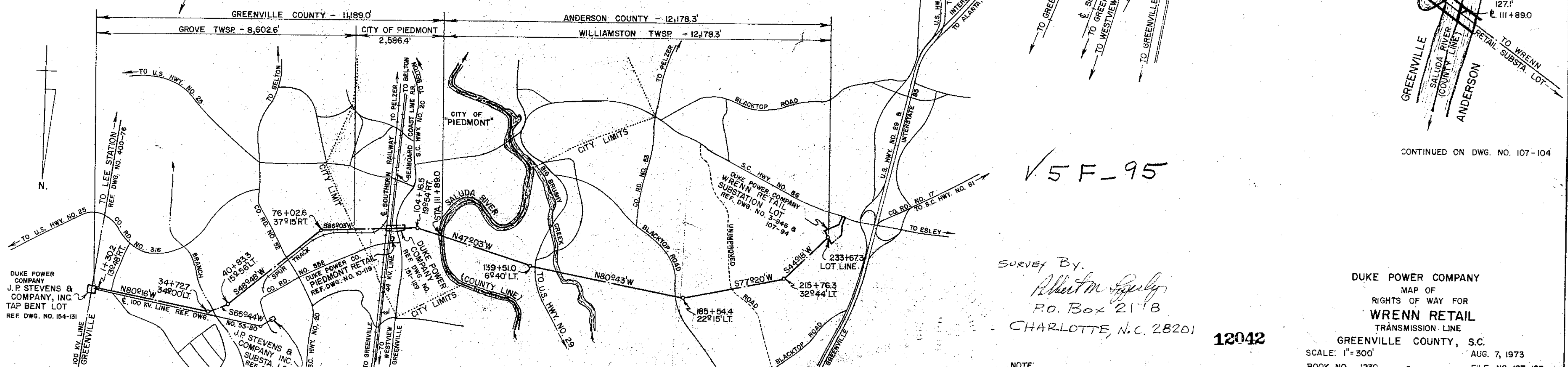

V5F-95

SURVEY BY
Albert M. Gentry
P.O. Box 2118
CHARLOTTE, N.C. 28201

12042

DUKE POWER COMPANY
MAP OF
RIGHTS OF WAY FOR
WRENN RETAIL
TRANSMISSION LINE
GREENVILLE COUNTY, S.C.

SCALE: 1"=300'
BOOK NO. 1230
FILE NO. 107-103

300 200 100 0 300 600 900

ALIGNMENT OF LINE
SCALE: 1"=2000'

NOTE:
DISTANCES SHOWN ON PROPERTY LINES
ARE FROM CORNER TO SURVEY LINE

CONTINUED ON DWG. NO. 107-104